

# PACIFIC

HELMETS

2019



**SAFETY  
WITHOUT  
COMPROMISE**







# *PACIFIC HELMETS IN* **NUMBERS**



## **3 DECADES OF EXPERIENCE**

Founded in 1982, we began building motorcycle helmets before switching focus to firefighting helmets.

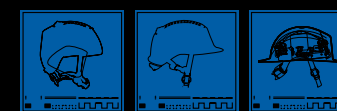

## **OVER 100 HELMETS DESIGNED**

Since 1980 we have developed over 100 unique helmet models and variations for firefighting, ambulance, rescue & more.



## **3 NZ DESIGN AWARDS**

Pacific Helmets won two Silver (2015 & 2017) and one gold (2016) award at the New Zealand *Best Design Awards*.



## **80 NATIONS DISTRIBUTED TO**

Pacific Helmets are shipped to more than 80 nations on every continent in the world except Antarctica.



## **25 HELMET MODELS AVAILABLE**

Our catalogue includes 25 different helmet models and variations available for order.



## **28 STANDARD CERTIFICATIONS**

Our helmets are certified to 24 different standards including various CE, MED, ANSI, NFPA, AS/NZS & CCC standards.



# WHY USE PACIFIC?

Flexible manufacturing processes and an innovative design team allow Pacific Helmets to offer customers the ability to customise helmets to suit their exact requirements and preferences.

Pacific Helmets is dedicated to ongoing Research and Development (R&D). We continuously seek to improve the method, material and safety of the helmets we produce.

- Customisation to brigade specific requirements and preferences
- Pacific Helmets certify to all major international standards i.e. ANSI, AS/NZS, EN, NFPA, ISO
- Widest range of helmet products from any single helmet manufacturer
- Extensive range of accessories
- Pacific Helmets' Kevlar®/fibreglass reinforced shells are lightweight and durable
- Extensive in-service life span
- Extremely Safe
- Comfortable
- Able to fit a wide range of head sizes through our adjustable ratchet headband system
- UV resistant, chemical resistant
- Made from premium raw materials
- Over three decades of proven reliability in the field
- High quality paint finish available in any colour, including photoluminescent
- Compatible with all other major PPE apparatus.

QMS\* CERTIFIED TO  
ISO 9001:2015

CERTIFICATES  
AVAILABLE  
BY REQUEST



## PACIFIC IS...

### EXPERIENCE

With over three decades of experience in the design and manufacture of premium safety helmets, Pacific Helmets specialises in manufacturing and exporting safety helmet products to the exact design and performance specifications of each customer.

Pacific Helmets strives to meet, where possible set, and to exceed the highest possible international standards for technical safety performance. Flexible manufacturing processes and innovative design philosophy result in products which have created new dimensions in helmet safety.

Pacific Helmets has an ongoing commitment to the development of new and innovative safety helmets and related products.

### EXPERTISE

There are three fundamental aspects that drive the design process:

- International Standards
- Practical requirements of fire fighters and rescue personnel
- Aesthetics and comfort

Pacific Helmets prides itself on the ability to provide helmets that are designed around all three criteria. Over three decades, Pacific Helmets has developed an inherent understanding of the relevant international standards and the resulting design implications. Pacific Helmets also prides itself on understanding the practical requirements of fire fighters and rescue personnel. Our helmets are certified to all major international standards.

### PASSION

Pacific Helmets is passionate about protecting people with the world's best safety gear, without compromise.





# CONTENTS

8



## CUSTOMISATION OPTIONS

Customise your helmets to meet your exact requirements

10



## STRUCTURAL FIREFIGHTING

Our range of modern jet style, 3/4 jet style and traditional style structural firefighting helmets

26



## WILDLAND FIREFIGHTING

Lightweight and customisable wildland/bushfire helmets

34



## PARAMEDIC / RESCUE / RECREATION

Multipurpose helmets designed for a wide range of emergency services & recreational uses

52



## ATV / QUAD

Lightweight Quadsafe / ATV (all terrain vehicle) helmets for farm use



# CUSTOMISATION OPTIONS

## CUSTOMISE YOUR SAFETY

- Over 10% of Pacific Helmets' staff are involved in full time research and development.
- With the widest range of international certified helmets, Pacific Helmets have a helmet for your exact safety needs. If not, we will make you one!\*
- Pacific Helmets offer the widest range of colour options.
- A wide range of comfort padding options available.
- Microbial resistant materials.
- Multiple chin strap and chin cup designs are available.
- Multiple options to provide airflow through your helmet with our open/close DSVS™ (Dynamic Sealed Ventilation System) or permanently open ventilation holes.\*\*
- Rapid water release options.
- Extra small and extra large sizing options are also available.

\* Minimum order quantity required.

\*\* Standards Dependant.

## ACCESSORIES

- Pacific Helmets are compatible with a wide range of accessories and complimentary components:
  - Neck protectors of many shapes, sizes, and materials with water and flame retardant options.
  - Lighting solutions.
  - Hearing protection.
  - Goggles, face shields, and safety glasses.
  - Communications.
  - Cameras.
  - We will custom fit your unique accessories.\*\*

## CUSTOM DECAL OPTIONS

- Extensive range of colours
- Badges/Crests.
- Wording.
- Reflectors.
- All decals can be placed under clear coat for extra protection.

## COLOUR CHOICES

We offer the widest range of colour options. If the colour you require is not shown below please contact us, as we can provide custom colours. Minimum order quantity for special color runs may apply. Helmets are painted with UV resistant paint, and come in a gloss finish. Some colours are available in a satin (matte) finish.

*Below is our standard colour range:*







# STRUCTURAL FIREFIGHTING

Our range of modern jet style, 3/4 jet style and traditional brim-style structural firefighting helmets

**10-25**





# F15

## STRUCTURAL FIREFIGHTING HELMET

JET STYLE



Best Design Awards  
Winner 2017



**CUSTOM**  
PLINTH DESIGN  
BY REQUEST



**OTEP™**  
ONE TOUCH EYE  
PROTECTOR



**COMMS**  
COMPATIBLE

The Pacific F15 Structural Fire Helmet combines the heritage and proven safety of Pacific's unique DuPont™ Kevlar® and Fibreglass reinforced composite shell technology with an advanced polymer chassis to revolutionize your firefighting experience.

The F15 incorporates Pacific's latest innovative designs such as the dual pivot face shield. Using an elliptic dual pivot system, the F15's new full coverage internal face shield can be fully deployed when in use with a breathing apparatus to provide you with an extra layer of safety. The F15 also comes with the One Touch Eye Protector (OTEP)™ for easy, push-activated eye protection at times when full face coverage is not required.

The composite shell provides excellent impact and penetration protection and is lightweight and resistant to chemical, UV, heat, and flame. Pacific shells have a proven service life of 15+ years' with proper care and maintenance. The unique chassis provides a platform for accessories and tech integration.

The F15 has an optimised center of gravity, giving it stability and making it feel lighter to wear. Combined with 5 specially designed stages of impact attenuation, the result is a helmet that reduces neck and spine fatigue and provides greater protection against falls and impacts.

### RECOMMENDED USES

**STRUCTURAL FIREFIGHTING**  
AS/NZS 4067:2012, NFPA 1971:2018, OR EN443:2008

**TECHNICAL RESCUE**  
NFPA 1951:2013

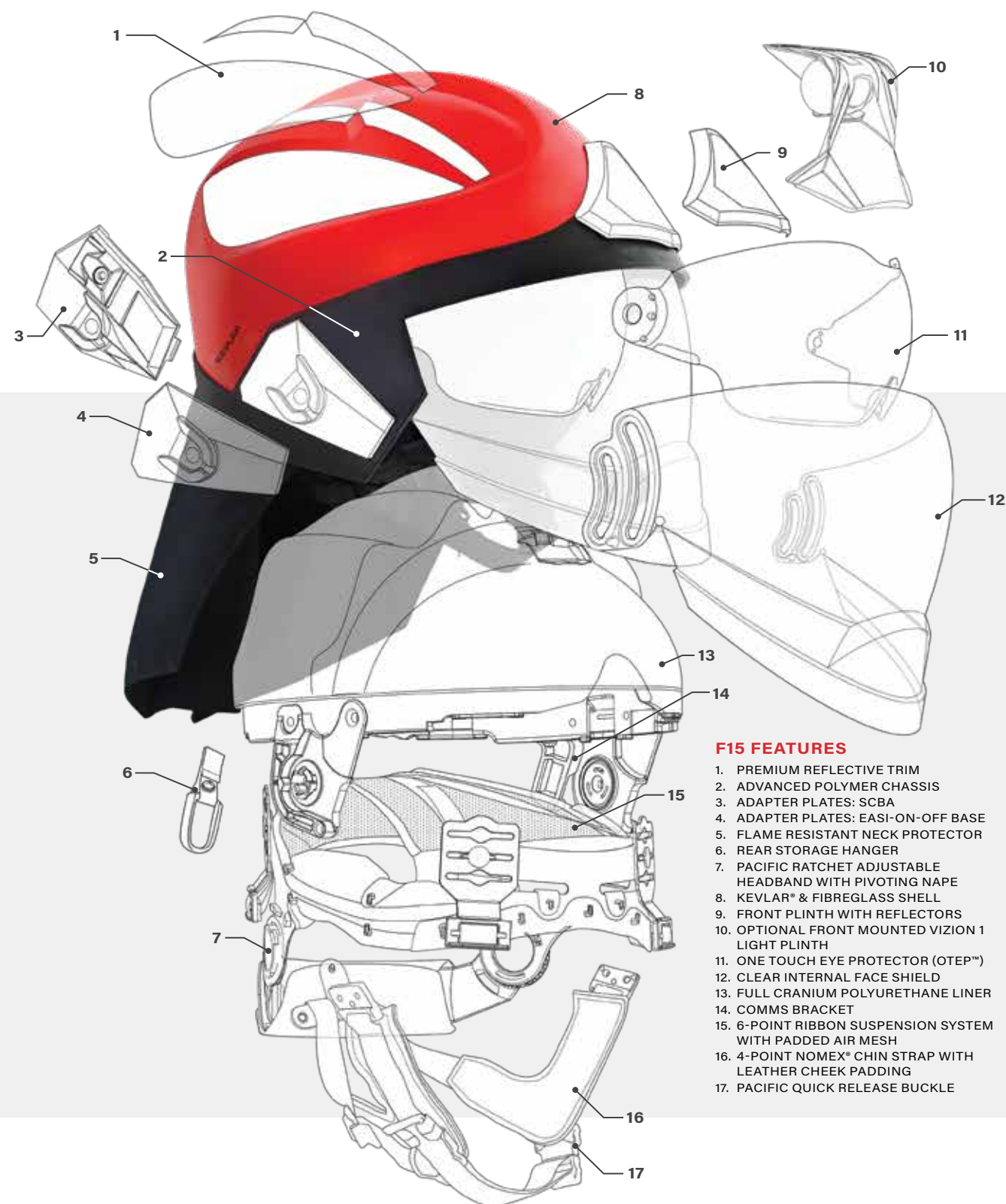

#### F15 FEATURES

1. PREMIUM REFLECTIVE TRIM
2. ADVANCED POLYMER CHASSIS
3. ADAPTER PLATES: SCBA
4. ADAPTER PLATES: EASI-ON-OFF BASE
5. FLAME RESISTANT NECK PROTECTOR
6. REAR STORAGE HANGER
7. PACIFIC RATCHET ADJUSTABLE HEADBAND WITH PIVOTING NAPE
8. KEVLAR® & FIBREGLASS SHELL
9. FRONT PLINTH WITH REFLECTORS
10. OPTIONAL FRONT MOUNTED VIZION 1 LIGHT PLINTH
11. ONE TOUCH EYE PROTECTOR (OTEP™)
12. CLEAR INTERNAL FACE SHIELD
13. FULL CRANIUM POLYURETHANE LINER
14. COMMS BRACKET
15. 6-POINT RIBBON SUSPENSION SYSTEM WITH PADDED AIR MESH
16. 4-POINT NOMEX® CHIN STRAP WITH LEATHER CHEEK PADDING
17. PACIFIC QUICK RELEASE BUCKLE

## F15 HELMET SPECIFICATIONS

### CERTIFICATIONS

- **Helmet** certified to the following standards:
  - AS/NZS 4067:2012 Structural Firefighting
  - EN 443:2008 Structural Firefighting
  - NFPA 1971:2018 Structural Firefighting
  - NFPA 1951:2013 Technical Rescue
  - MED Module B Marine Firefighting
- **Face Shield** is certified to the following standards:
  - AS/NZS 13371:2010
  - EN 14458:2004
  - NFPA 1971:2018
- **Eye Protector** is certified to the following standards:
  - AS/NZS 13371:2010
  - ANSI Z87.1
  - EN 166:2001
  - EN 14458:2004
  - NFPA 1971:2018

### SIZING

Headband adjusts between 52-65cm. Downsize Kit or Extra Large Headband are also available for smaller or larger head sizes.

### CARE

All parts can be removed with simple tools to enable your helmet to be cleaned and maintained.

### WARRANTY

Parts are covered for manufacturing defects and vary from 1-6 years for different helmet components.





# F18

## STRUCTURAL FIREFIGHTING HELMET

TRADITIONAL STYLE



**CUSTOM**  
PLINTH DESIGN  
BY REQUEST



**OTEP™**  
ONE TOUCH EYE  
PROTECTOR



**COMMS**  
COMPATIBLE

The Pacific F18 is the latest addition to the Pacific Range, a traditional style structural firefighting helmet with a modern interior. The F18 combines the latest innovative interior designs from Pacific helmets with popular features from the traditional style, all combined into a lightweight package. Pacific's Generation 2 Liner is fitted to the F18 which optimises the feel of the helmet on your head. It comes with a 2 point chinstrap with Postman's buckle to allow quick adjustment, and can be fitted with a leather front shield and holder.

### RECOMMENDED USES

**STRUCTURAL FIREFIGHTING**  
NFPA 1971:2018

**TECHNICAL RESCUE**  
NFPA 1951:2013



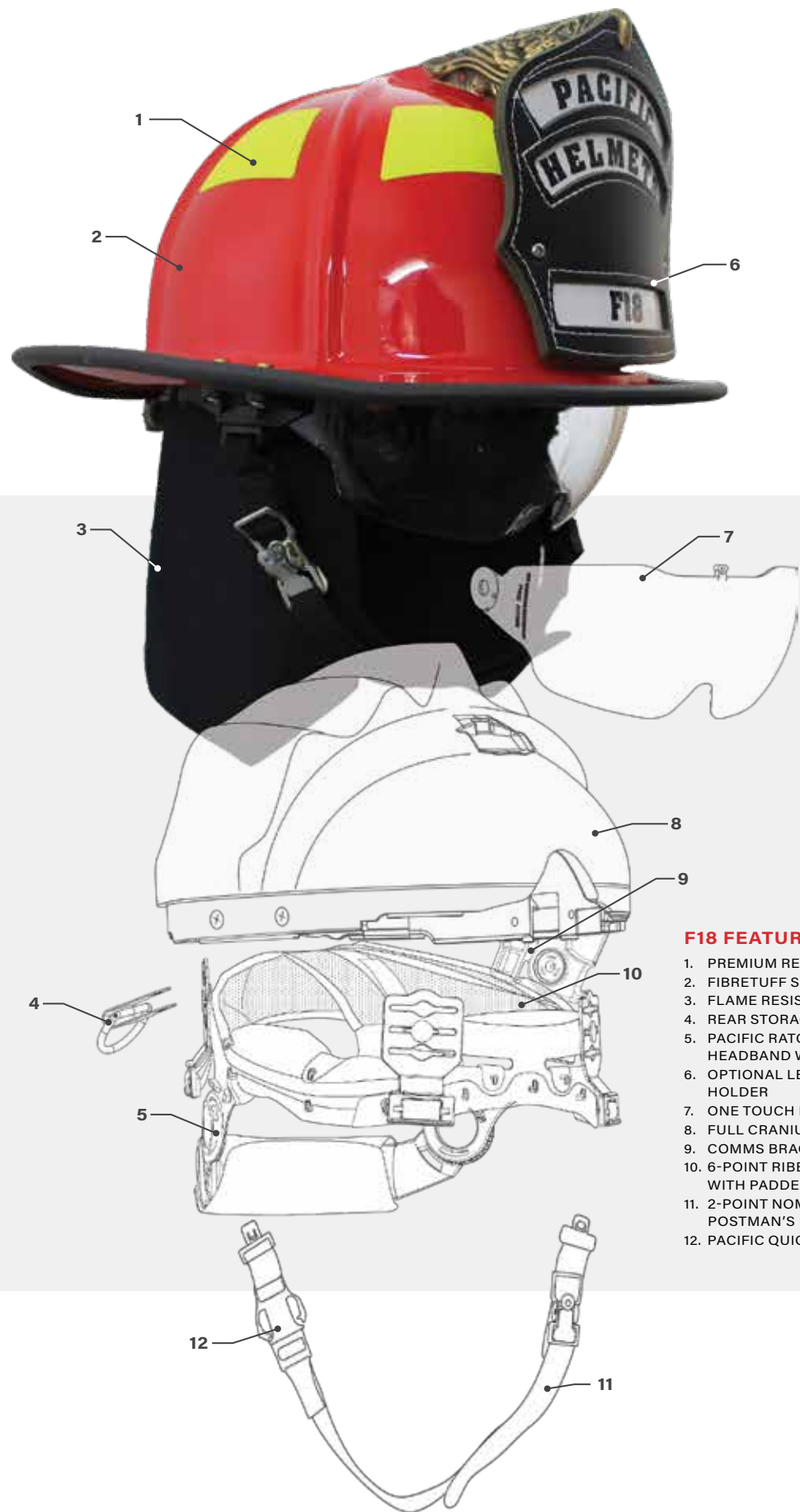

#### F18 FEATURES

1. PREMIUM REFLECTIVE TRIM
2. FIBREUFF SHELL
3. FLAME RESISTANT NECK PROTECTOR
4. REAR STORAGE HANGER
5. PACIFIC RATCHET ADJUSTABLE HEADBAND WITH PIVOTING NAPE
6. OPTIONAL LEATHER FRONT PLINTH + HOLDER
7. ONE TOUCH EYE PROTECTOR (OTEP™)
8. FULL CRANIUM POLYURETHANE LINER
9. COMMS BRACKET
10. 6-POINT RIBBON SUSPENSION SYSTEM WITH PADDED AIR MESH
11. 2-POINT NOMEX® CHIN STRAP WITH POSTMAN'S BUCKLE
12. PACIFIC QUICK RELEASE BUCKLE

## F18 HELMET SPECIFICATIONS

### CERTIFICATIONS

- **Helmet** certified to the following standards:
  - NFPA 1971:2018 Structural Firefighting
  - NFPA 1951:2013 Technical Rescue
- **Eye Protector** is certified to the following standards:
  - ANSI Z87.1
  - NFPA 1971:2018

### SIZING

Headband adjusts between 52-65cm. Downsize Kit or Extra Large Headband are also available for smaller or larger head sizes.

### CARE

All parts can be removed with simple tools to enable your helmet to be cleaned and maintained.

### WARRANTY

Parts are covered for manufacturing defects and vary from 1-6 years for different helmet components.





# F11 DRAGONFLY

## STRUCTURAL FIREFIGHTING HELMET

3/4 JET STYLE



**EARMUFF**  
BRACKETS  
(25 OR 30MM)



**OTEP™**  
ONE TOUCH EYE  
PROTECTOR



**COMMS**  
COMPATIBLE

The Pacific F11 offers a fresh take on structural fire helmet design. The F11 has been designed to maximise protection and practicality for the diverse range of duties modern Emergency Service personnel are called on to perform. Certified to AS/NZS 4067:2012, NFPA 1971:2018 & NFPA 1951:2013, and EN 443:2008 the F11 is a compact helmet ideal not only for structural firefighting but also for road crash rescue and confined space work. The compact design of the F11 makes it a truly multipurpose structural firefighting helmet.

The F11 features the DuPont™ Kevlar® and fibreglass reinforced composite shell, and full cranium protective polyurethane foam liner. That not only gives excellent impact and penetration protection but also deceleration impact and side impact protection that the AS/NZS 4067: 2012 standard requires.

As a complete safety platform the F11 offers boom microphone and speaker compatibility, an individualised fit, and a full range of face and hearing protection. Available with a 3 or 4-point chin strap the F11 features Pacific's next generation headband with pivoting nape for enhanced comfort and secure fit to all head shapes and sizes. The face and hearing protection options include a full external face shield that is available in the customer's preference of either a fixed hinge or clip-on hinge option, a One Touch Eye Protector (OTEP)™, and clip-on hearing protection.

### RECOMMENDED USES

**STRUCTURAL FIREFIGHTING**  
AS/NZS 4067:2012, NFPA 1971:2018, OR EN 443:2008

**TECHNICAL RESCUE**  
NFPA 1951:2013



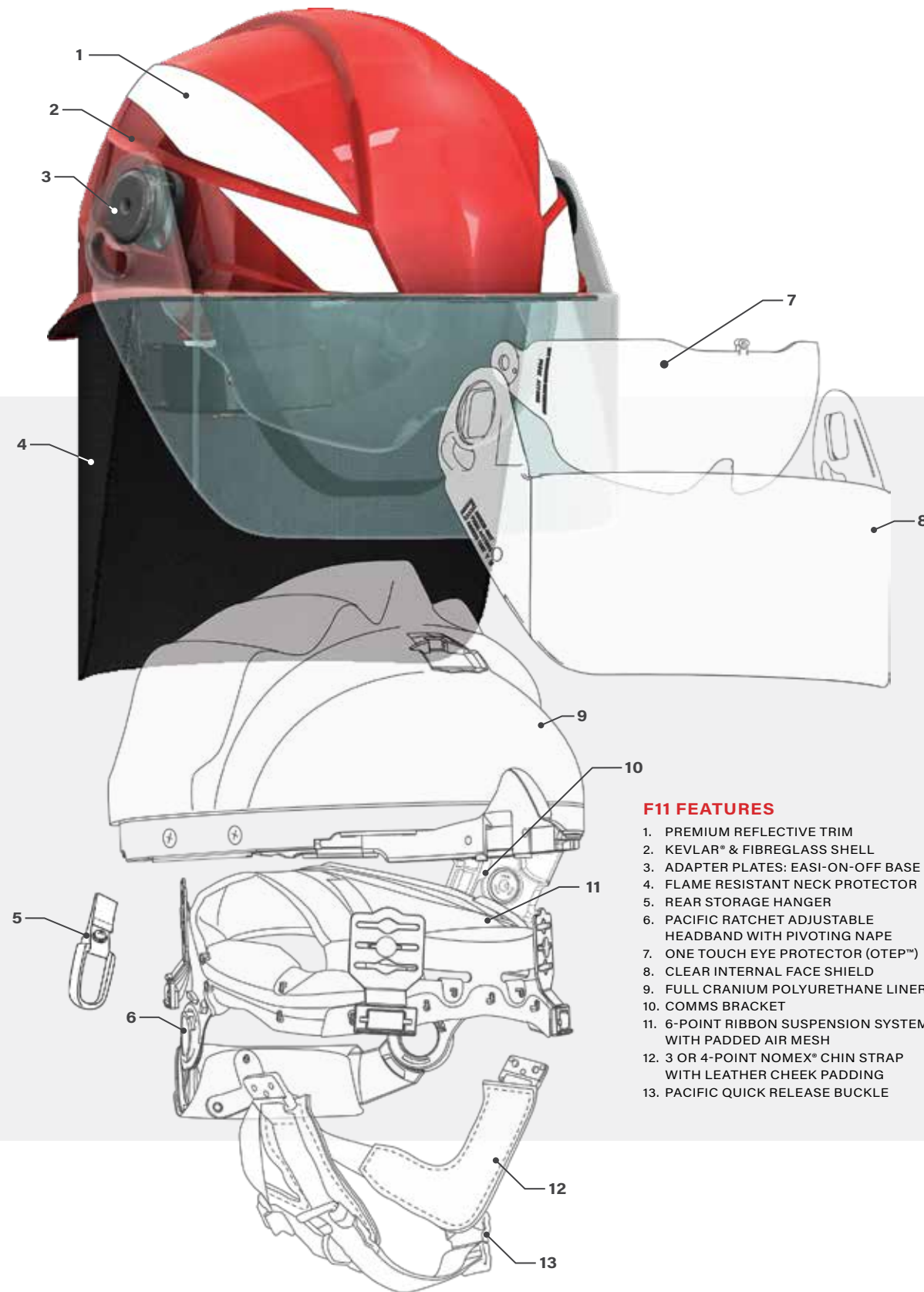

#### F11 FEATURES

1. PREMIUM REFLECTIVE TRIM
2. KEVLAR® & FIBREGLASS SHELL
3. ADAPTER PLATES: EASI-ON-OFF BASE
4. FLAME RESISTANT NECK PROTECTOR
5. REAR STORAGE HANGER
6. PACIFIC RATCHET ADJUSTABLE HEADBAND WITH PIVOTING NAPE
7. ONE TOUCH EYE PROTECTOR (OTEP™)
8. CLEAR INTERNAL FACE SHIELD
9. FULL CRANIUM POLYURETHANE LINER
10. COMMS BRACKET
11. 6-POINT RIBBON SUSPENSION SYSTEM WITH PADDED AIR MESH
12. 3 OR 4-POINT NOMEX® CHIN STRAP WITH LEATHER CHEEK PADDING
13. PACIFIC QUICK RELEASE BUCKLE

## F11 DRAGONFLY SPECIFICATIONS

### CERTIFICATIONS

- **Helmet** certified to the following standards:
  - AS/NZS 4067:2012 Structural Firefighting
  - EN 443:2008 Structural Firefighting
  - NFPA 1971:2018 Structural Firefighting
  - NFPA 1951:2013 Technical Rescue
- **Face Shield** is certified to the following standards:
  - AS/NZS 13371:2010
  - EN 14458:2004
  - NFPA 1971:2018
- **Eye Protector** is certified to the following standards:
  - AS/NZS 13371:2010
  - ANSI Z87.1
  - EN 166:2001
  - EN 14458:2004
  - NFPA 1971:2018

### SIZING

Headband adjusts between 52-65cm. Downsize Kit or Extra Large Headband are also available for smaller or larger head sizes.

### CARE

All parts can be removed with simple tools to enable your helmet to be cleaned and maintained.

### WARRANTY

Parts are covered for manufacturing defects and vary from 1-6 years for different helmet components.



# F10 MKV

STRUCTURAL FIREFIGHTING HELMET

3/4 JET STYLE



The Pacific F10 MkV combines safety, comfort, quality and style. With a DuPont™ Kevlar® and Fibreglass Reinforced Composite Shell, the F10 MkV is incredibly light and, like all Pacific helmets, is designed to last you a lifetime. The optimised shape and low ride height enhances the balanced feel of the helmet to provide you a comfortable fit over long periods of wear.

### CERTIFICATIONS

- **HELMET**  
AS/NZS 4067:2012, EN443:2008, NFPA 1971:2018, NFPA 1951:2013
- **FACE SHIELD**  
AS/NZS 13371:2010, EN 14458:2004, NFPA 1971:2018
- **EYE PROTECTOR**  
AS/NZS 13371:2010, ANSI Z87.1, EN 166:2001, EN 14458:2004, NFPA 1971:2018

### RECOMMENDED USES

- STRUCTURAL FIREFIGHTING  
AS/NZS 4067:2012, NFPA 1971:2018, OR EN443:2008
- TECHNICAL RESCUE  
NFPA 1951:2013

# F10 MKIII

STRUCTURAL FIREFIGHTING HELMET

3/4 JET STYLE



The F10 MkIII embodies Pacific's core design philosophies of safety, quality and comfort. Design features include internal bubble face shield and unique One Touch Eye Protector™ (OTEP). Accentuated shell lines provide improved shock absorption and structural rigidity.

### CERTIFICATIONS

- **HELMET**  
AS/NZS 4067:2012, NFPA 1971:2018, NFPA 1951:2013, EN 443:2008 (Pending)
- **FACE SHIELD**  
AS/NZS 13371:2010, EN 14458:2004, NFPA 1971:2018
- **EYE PROTECTOR**  
AS/NZS 13371:2010, ANSI Z87.1, EN 166:2001, EN 14458:2004, NFPA 1971:2018

### RECOMMENDED USES

- STRUCTURAL FIREFIGHTING  
AS/NZS 4067:2012, EN 443:2008, OR NFPA 1971:2018
- TECHNICAL RESCUE  
NFPA 1951:2013

# F3D MKII

STRUCTURAL FIREFIGHTING HELMET

TRADITIONAL STYLE



The Pacific F3D MkII is a cornerstone model of the Pacific range. The F3D MkII is used around the world and has a proven track record of being an extremely safe, robust and long lasting helmet. Continuous improvements to both design and raw materials has meant that the F3D MkII easily exceeds the latest editions of AS/NZS 4067:2012 & EN 443:2008 while remaining one of the lightest and most comfortable structural firefighting helmets available in the world today. Additionally the F3D MkII is now available with our enhanced second generation liner system for even greater comfort.

### CERTIFICATIONS

- **HELMET**  
AS/NZS 4067:2012, EN 443:2008, MED Module B
- **FACE SHIELD**  
AS/NZS 13371:2010, EN 14458:2004, EN 166:2001

### RECOMMENDED USES

- STRUCTURAL FIREFIGHTING  
AS/NZS 4067:2012, OR EN 443:2008

# F6

STRUCTURAL FIREFIGHTING HELMET

TRADITIONAL STYLE



The F6 is certified to NFPA 1971 and AS/NZS 4067. Made with a Fibretuff shell, the F6 can be fitted with both a One Touch Eye Protector™ (OTEP) or an External Face Shield.

### CERTIFICATIONS

- **HELMET**  
AS/NZS 4067:2012, NFPA 1971:2018
- **FACE SHIELD**  
NFPA 1971:2018, AS/NZS 1337.2010
- **EYE PROTECTOR**  
ANSI Z87.1 2015

### RECOMMENDED USES

- STRUCTURAL FIREFIGHTING  
AS/NZS 4067:2012, OR NFPA 1971:2018





# **WILDLAND FIREFIGHTING**

Lightweight and customisable  
wildland/bushfire helmets

**26-33**



# R6 CHALLENGER

## WILDLAND FIREFIGHTING HELMET

COMPACT STYLE



**EARMUFF**  
BRACKETS  
(25 OR 30MM)



**PICATINNY**  
RAILS OPTIONAL



**COMMS**  
COMPATIBLE

The R6 Challenger is the leader in Pacific's flagship R6 rescue helmet series. As a truly multi-purpose helmet, the Challenger is fully certified to the widest range of rescue helmet standards of any helmet in the world; AS/NZS 1801:1997 Type 3, EN 16471:2014, EN 16473:2014, and NFPA 1951:2013.

Complementing its modern compact design, user comfort, and superior protection, the Challenger offers compatibility with a wide range of accessories and additional protective equipment. For face protection, the Challenger can accommodate either clip on or fixed external face shields (clear polycarbonate or mesh options), internal eye protection, and goggle straps or clips to support a range of safety goggles. Additional compatibilities include brackets to support earmuffs, an interchangeable range of neck protectors, multiple torch/lamp attachment options, picatinny rails, and boom microphone and speaker compatibility.

The Challenger provides the user with the highest level of rescue/wildland fire protection currently available in the world today. It is the multipurpose helmet of choice for many rescue, wildland fire and military services across the globe.

*Please note: the R6 Challenger was previously called the R6C.*

### RECOMMENDED USES

**WILDLAND FIREFIGHTING**  
AS/NZS 1801:1997 TYPE 3, OR EN 16471:2014

**USAR, PARAMEDIC & RESCUE**  
NFPA 1951:2013, AS/NZS 1801:1997 TYPE 2, OR EN 16473:2014

**INDUSTRIAL SAFETY**  
AS/NZS 1801:1997 TYPE 1 & 2, ANSI Z89.1, OR EN 397:2012



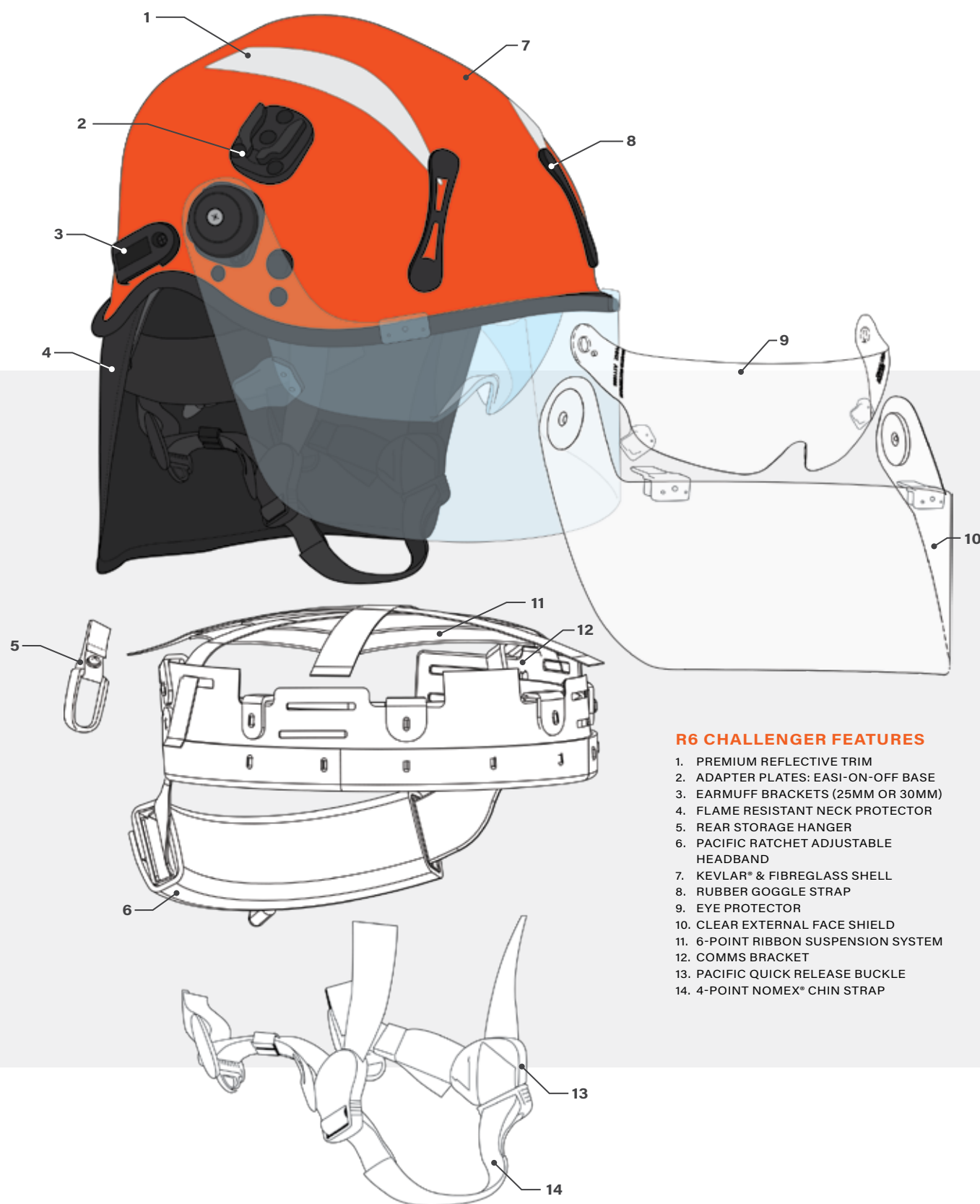

#### R6 CHALLENGER FEATURES

1. PREMIUM REFLECTIVE TRIM
2. ADAPTER PLATES: EASI-ON-OFF BASE
3. EARMUFF BRACKETS (25MM OR 30MM)
4. FLAME RESISTANT NECK PROTECTOR
5. REAR STORAGE HANGER
6. PACIFIC RATCHET ADJUSTABLE HEADBAND
7. KEVLAR® & FIBREGLASS SHELL
8. RUBBER GOGGLE STRAP
9. EYE PROTECTOR
10. CLEAR EXTERNAL FACE SHIELD
11. 6-POINT RIBBON SUSPENSION SYSTEM
12. COMMS BRACKET
13. PACIFIC QUICK RELEASE BUCKLE
14. 4-POINT NOMEX® CHIN STRAP

## R6 CHALLENGER SPECIFICATIONS

### CERTIFICATIONS

- **Helmet** certified to the following standards:
  - AS/NZS 1801:1997 Type 1 & 2 Industrial
  - AS/NZS 1801:1997 Type 2 Technical Rescue
  - AS/NZS 1801:1997 Type 3 Wildland Firefighting
  - EN 16471:2014 Wildland Firefighting
  - EN 16473:2014 Technical Rescue
  - NFPA 1951:2013 Technical Rescue
  - EN 397:2012 Industrial
  - Compliant: ANSI Z89.1 Industrial
- **Eye Protector** is certified to the following standards:
  - AS/NZS 13371:2010
  - ANSI Z87.1:2015
  - EN 166:2001
  - EN 14458:2004

### SIZING

Headband adjusts between 52-65cm. Downsize Kit or Extra Large Headband are also available for smaller or larger head sizes.

### CARE

All parts can be removed with simple tools to enable your helmet to be cleaned and maintained.

### WARRANTY

Parts are covered for manufacturing defects and vary from 1-6 years for different helmet components.

# BR5 MKII

WILDLAND FIREFIGHTING HELMET

WIDE BRIM STYLE



Our heritage wide-brim wildland firefighting helmet. The classic design focuses on delivering safety, quality and comfort to the user.

CERTIFICATIONS

■ HELMET  
AS/NZS 1801:1997 Type 3

RECOMMENDED USES

WILDLAND FIREFIGHTING  
AS/NZS 1801:1997 Type 3

# BR5 MKII C

WILDLAND FIREFIGHTING HELMET

CAP STYLE



A lightweight wildland firefighting helmet with a cap-style brim differentiating it from the standard BR5 MkII model.

CERTIFICATIONS

■ HELMET  
AS/NZS 1801:1997 Type 3

RECOMMENDED USES

WILDLAND FIREFIGHTING  
AS/NZS 1801:1997 Type 3

# BR9

WILDLAND FIREFIGHTING HELMET

STANDARD STYLE



The standard BR9 is a popular lightweight wildfire helmet. The standard shape incorporates a narrow side brim and multiple crown ridges allow for extra strength and air flow. Also available in a wide brim shell. Face shield and eye protector are optional.

CERTIFICATIONS

■ HELMET  
AS/NZS 1801:1997 Type 3

■ EYE PROTECTOR  
AS/NZS 13371:2010, ANSI Z87.1, EN 166:2001, EN 14458:2004, NFPA 1971:2018

RECOMMENDED USES

WILDLAND FIREFIGHTING  
AS/NZS 1801:1997 Type 3

# BR9SC

WILDLAND FIREFIGHTING HELMET

CAP STYLE



The BR9SC is a versatile head protection platform for emergency services that can support a full range of accessories. The cap style shell design has a short front brim, no rear brim and a scallop cut on both sides for better earmuff mounting and stowage. Also available in a wide brim shell. Face shield and eye protector are optional.

CERTIFICATIONS

■ HELMET  
AS/NZS 1801:1997 Type 3

■ EYE PROTECTOR  
AS/NZS 13371:2010, ANSI Z87.1, EN 166:2001, EN 14458:2004, NFPA 1971:2018

RECOMMENDED USES

WILDLAND FIREFIGHTING  
AS/NZS 1801:1997 Type 3





## PARAMEDIC, RESCUE & RECREATION

Multipurpose helmets designed for a wide range  
of emergency services and recreational uses

**34-53**





# R6L PATROLLER

## MULTIPURPOSE SAFETY HELMET

COMPACT STYLE



Best Design Awards  
Winner 2016



VAS SHROUD  
FRONTAL MOUNT  
OPTIONAL



PICATINNY  
RAILS  
STANDARD



COMMS  
COMPATIBLE

The R6L Patroller is a lightweight helmet which can be configured for a wide range of uses from Industrial to Wildland Firefighting. With its military styling, the Patroller has been designed to accommodate tactical Picatinny Rails and VAS shroud for attaching extra equipment such as cameras, earmuffs, torch, night vision goggles, and face protection. It has a larger shell than the other R6 Series helmets, which also makes it a great choice for larger head sizes due to the increased internal space. The Patroller can also be configured like a standard Pacific Helmet with features such as external clip-on face shield.

The Patroller was awarded a Gold at the New Zealand Best Design Awards in 2016.

*Please note: the R6L Patroller was previously called the R6R.*

### RECOMMENDED USES

USAR, PARAMEDIC & RESCUE  
NFPA 1951:2013, AS/NZS 1801:1997 TYPE 2, OR EN16473:2014

WILDLAND FIREFIGHTING  
AS/NZS 1801:1997 TYPE 3, OR EN 16471:2014

INDUSTRIAL SAFETY  
AS/NZS 1801:1997 TYPE 1 & 2, ANSI Z89.1:2014, OR EN 397:2012



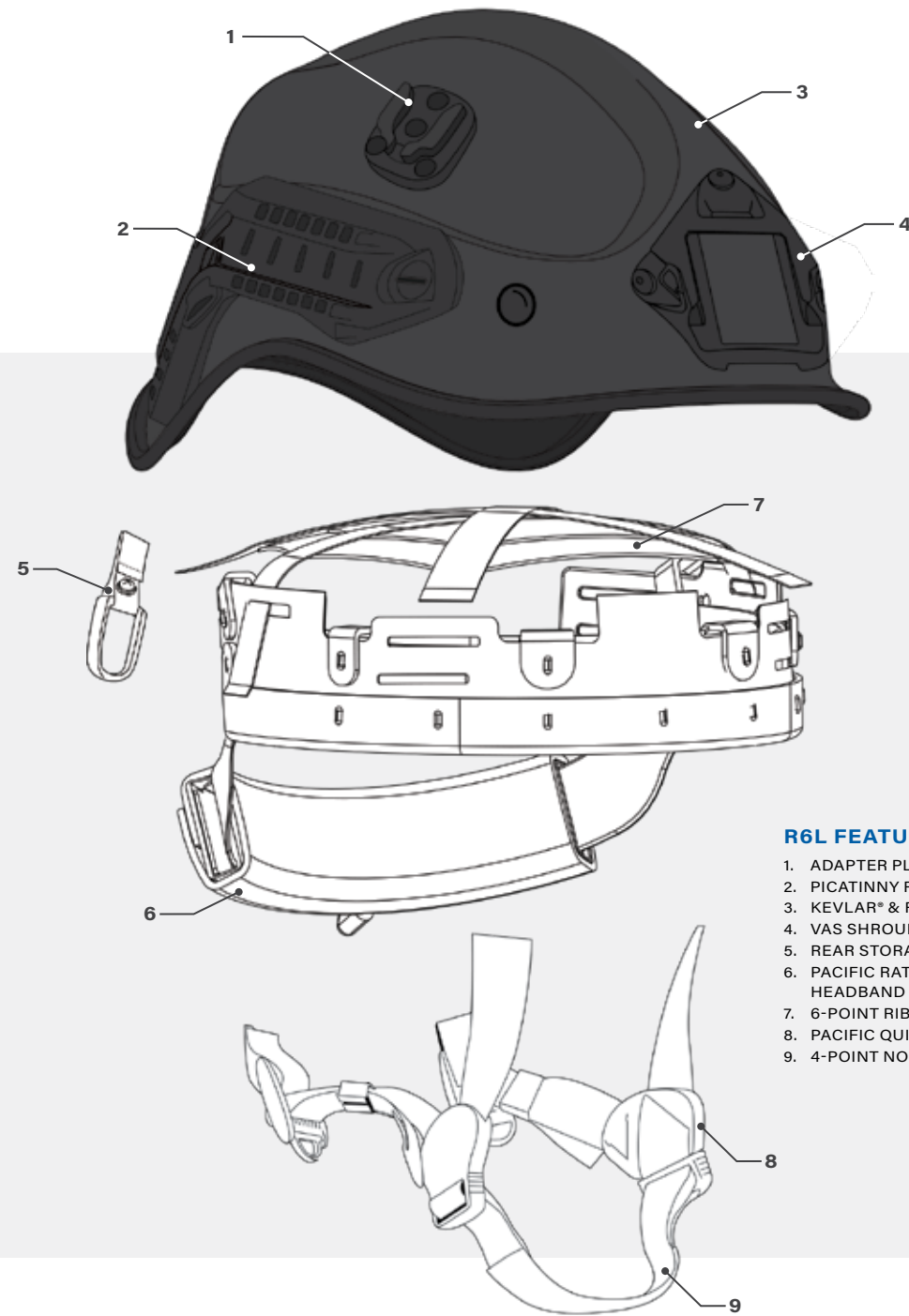

#### R6L FEATURES

1. ADAPTER PLATES: EASI-ON-OFF BASE
2. PICATINNY RAILS
3. KEVLAR® & FIBREGLASS SHELL
4. VAS SHROUD FRONTAL MOUNTING
5. REAR STORAGE HANGER
6. PACIFIC RATCHET ADJUSTABLE HEADBAND
7. 6-POINT RIBBON SUSPENSION SYSTEM
8. PACIFIC QUICK RELEASE BUCKLE
9. 4-POINT NOMEX® CHIN STRAP

## R6L PATROLLER SPECIFICATIONS

### CERTIFICATIONS

- **Helmet** certified to the following standards:
  - AS/NZS 1801:1997 Type 1 & 2 Industrial
  - AS/NZS 1801:1997 Type 2 Technical Rescue
  - AS/NZS 1801:1997 Type 3 Wildland Firefighting
  - EN 16471:2014 Wildland Firefighting
  - EN 16473:2014 Technical Rescue
  - NFPA 1951:2013 Technical Rescue
- **Eye Protector** is certified to the following standards:
  - ANSI Z87.1:2015 Eye Protector
  - EN 166:2001 Eye Protector
  - EN 14458:2004 Eye Protector
  - EN 13371:2010 Eye Protector

### SIZING

Headband adjusts between 52-65cm. Downsize Kit or Extra Large Headband are also available for smaller or larger head sizes.

### CARE

All parts can be removed with simple tools to enable your helmet to be cleaned and maintained.

### WARRANTY

Parts are covered for manufacturing defects and vary from 1-6 years for different helmet components.





# R6V DOMINATOR

MULTIPURPOSE SAFETY HELMET

COMPACT STYLE



**PICATINNY**  
RAILS  
OPTIONAL



**DSVS™**  
VENT SEALS  
OPEN / CLOSE



**COMMS**  
COMPATIBLE

If you're looking for a lightweight vented helmet, choose the R6V Dominator. The Dominator features our Dynamic Sealed Ventilation System (DSVS™) which is water tight when closed, and sports a modern compact design that focuses on user comfort and protection. The Dominator can carry multiple accessories to create a helmet to your requirements and is suitable for mountaineering, USAR, paramedic, rescue, and industrial uses.

*Please note: the R6V Dominator was previously called the R6D.*

## RECOMMENDED USES

**USAR, PARAMEDIC & RESCUE**  
AS/NZS 1801:1997 TYPE 2, EN 12492, OR EN 16473:2014

**WILDLAND FIREFIGHTING**  
EN16471:2014

**INDUSTRIAL SAFETY**  
AS/NZS 1801:1997 TYPE 1 & 2, EN 397:2012, OR ANSI Z89.1



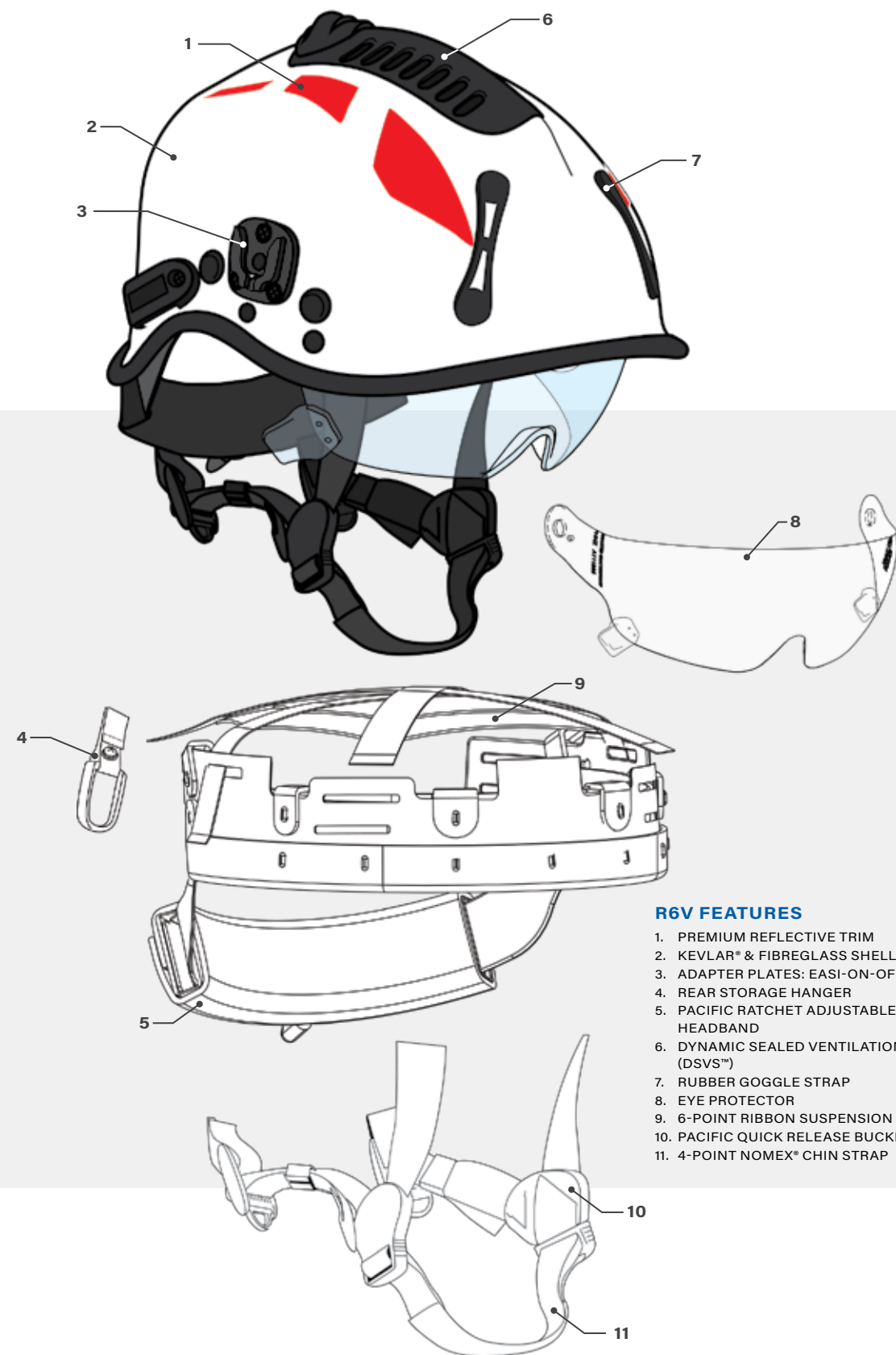

## R6V DOMINATOR SPECIFICATIONS

### CERTIFICATIONS

- **Helmet** certified to the following standards:
  - AS/NZS 1801:1997 Type 1 & 2 Industrial
  - AS/NZS 1801:1997 Type 2 Technical Rescue
  - EN 16471:2014 Wildland Firefighting
  - EN 16473:2014 Technical Rescue
  - EN 12472:2012 Mountaineering
  - Compliant: ANSI Z89.1 Industrial
- **Eye Protector** is certified to the following standards:
  - EN 166:2001 Eye Protector
  - EN 14458:2004 Eye Protector
  - EN 13371:2010 Eye Protector
  - ANSI Z87.1:2015 Eye Protector

### SIZING

Headband adjusts between 52-65cm. Downsize Kit or Extra Large Headband are also available for smaller or larger head sizes.

### CARE

All parts can be removed with simple tools to enable your helmet to be cleaned and maintained.

### WARRANTY

Parts are covered for manufacturing defects and vary from 1-6 years for different helmet components.





# R6V MKII *SEEKER*

WATER RESCUE & RECREATION HELMET

COMPACT STYLE



**DSVS™**  
VENT SEALS  
OPEN / CLOSE



**COMMS**  
COMPATIBLE



**EAR COVERS**  
OPTIONAL

The R6V MkII Seeker is a departure from the traditional configuration of rescue and bushfire helmets that Pacific make. The Seeker has a Fibretuff (fibreglass reinforced) composite shell with a single-piece form-moulded polyethylene (PE) liner.

The Seeker continues the Pacific tradition of creating versatile helmets that also serve as a platform for multiple accessories, with features such as attachable ear covers, torch base, Pacific's new rubber goggle straps, and the ability to attach a range of helmet mounted communication units. It's specialised Dynamic Sealed Ventilation System (DSVS™) can be opened and closed depending on the situation - when closed the vent is sealed, water tight.

The Seeker is a purpose-specific model of helmet designed for Recreation and Water Rescue situations.

## RECOMMENDED USES

**WATER RESCUE & RECREATION**  
EN 1385 & EN 443 S.C





#### R6V MKII FEATURES

1. PREMIUM REFLECTIVE TRIM
2. FIBRETUFF FIBREGLASS SHELL
3. DYNAMIC SEALED VENTILATION SYSTEM (DSVS™)
4. ADAPTER PLATES: EASI-ON-OFF BASE
5. WATER RELEASE HOLES
6. FORMED PE PADDING FOR COMFORT & IMPACT PROTECTION
7. PACIFIC RATCHET ADJUSTABLE HEADBAND
8. PACIFIC QUICK RELEASE BUCKLE
9. 4-POINT NOMEX® CHIN STRAP

## R6V MKII SEEKER SPECIFICATIONS

### CERTIFICATIONS

- **Helmet** certified to the following standards:
  - EN 1385:2012 Helmets for Canoeing
  - EN 443:2008 Selected Clauses

### SIZING

Headband adjusts between 52-65cm. Downsize Kit or Extra Large Headband are also available for smaller or larger head sizes.

### CARE

All parts can be removed with simple tools to enable your helmet to be cleaned and maintained.

### WARRANTY

Parts are covered for manufacturing defects and vary from 1-6 years for different helmet components.

# R3V4

MULTIPURPOSE SAFETY HELMET

CAP STYLE



The R3v4 is a versatile multipurpose helmet that has become one of Pacific's most popular USAR helmets year after year.

The helmet features a fibreglass shell reinforced with DuPont™ Kevlar® and full cranium impact liner, essentially making it a compact version of a full structural firefighting helmet. It offers the ultimate level of safety in all possible situations.

The R3v4 is also available, with some additional features, dual certified to NFPA 1971 and NFPA 1951.

*Note: Goggles not included.*

## CERTIFICATIONS

- **HELMET**  
NFPA 1971:2018, NFPA 1977:2016, NFPA 1951:2013

## RECOMMENDED USES

- **TECHNICAL RESCUE**  
NFPA 1951:2013
- **STRUCTURAL FIREFIGHTING**  
NFPA 1971:2018
- **INDUSTRIAL SAFETY**  
ANSI Z89.1 COMPLIANT

# R5S

MULTIPURPOSE SAFETY HELMET

CAP STYLE



The R5S features a small shell and can be made with no front brim to reduce the size even further. The small size makes it the perfect helmet for when working in tight or confined spaces.

## CERTIFICATIONS

- **HELMET**  
NFPA 1951:2013, ANSI Z89.1, EN 397:2012
- **FACE SHIELD**  
AS/NZS 13371:2010, EN 14458:2004, NFPA 1971:2018
- **EYE PROTECTOR**  
AS/NZS 13371:2010, ANSI Z87.1, EN 166:2001, EN 14458:2004, NFPA 1971:2018

## RECOMMENDED USES

- **TECHNICAL RESCUE**  
NFPA 1951:2013
- **INDUSTRIAL SAFETY**  
ANSI Z89.1, OR EN 397:2012

# R5SL

MULTIPURPOSE SAFETY HELMET

CAP STYLE



The R5SL features a slightly longer shell than the R5S which enables it to fit comfortably on a wider range of head sizes.

## CERTIFICATIONS

- **HELMET**  
NFPA 1951:2013, NFPA 1977:2016, AS/NZS 1801:1997 TYPE 1 & 2, ANSI Z89.1, EN 397:2012
- **FACE SHIELD**  
AS/NZS 13371:2010, EN 14458:2004, NFPA 1971:2018
- **EYE PROTECTOR**  
AS/NZS 13371:2010, ANSI Z87.1, EN 166:2001, EN 14458:2004, NFPA 1971:2018

## RECOMMENDED USES

- **TECHNICAL RESCUE**  
NFPA 1951:2013
- **WILDLAND FIREFIGHTING**  
NFPA 1977:2016
- **INDUSTRIAL SAFETY**  
AS/NZS 1801:1997 TYPE 1 & 2, ANSI Z89.1, OR EN 397:2012

# R5SLV

MULTIPURPOSE SAFETY HELMET

CAP STYLE



The R5SLV features the Dynamic Sealed Ventilation System (DSVS™) which is watertight when closed. Comes standard with a 4 point chinstrap for extra security and stability.

## CERTIFICATIONS

- **HELMET**  
AS/NZS 1801:1997 TYPE 1 & 2, EN 1249:2012, AS/NZS 1801:1997 TYPE 1 & 2, ANSI Z89.1, EN 397:2012
- **FACE SHIELD**  
AS/NZS 13371:2010, EN 14458:2004, NFPA 1971:2018
- **EYE PROTECTOR**  
AS/NZS 13371:2010, ANSI Z87.1, EN 166:2001, EN 14458:2004, NFPA 1971:2018

## RECOMMENDED USES

- **TECHNICAL RESCUE**  
AS/NZS 1801:1997 TYPE 1 & 2, OR EN 1249:2012
- **INDUSTRIAL SAFETY**  
AS/NZS 1801:1997 TYPE 1 & 2, ANSI Z89.1, OR EN 397:2012



# R7H

MULTIPURPOSE SAFETY HELMET

CAP STYLE



The R7H features a solid closed crown and can be made with or without a front peak. A wide range of available features mean this helmet can be used for a variety of situations.

CERTIFICATIONS

- **HELMET**  
AS/NZS 1801:1997 Type 1 & 2, EN397:2012, ANSI Z89.1

RECOMMENDED USES

- **TECHNICAL RESCUE**  
AS/NZS 1801:1997 TYPE 2
- **INDUSTRIAL SAFETY**  
AS/NZS 1801:1997 TYPE 1 & 2, EN397:2012, OR ANSI Z89.1

# R7HVEP

MULTIPURPOSE SAFETY HELMET

CAP STYLE



The R7HVEP features the Dynamic Sealed Ventilation System (DSVS™) which is watertight when closed. Can be fitted with eye protection and a number of other accessories.

CERTIFICATIONS

- **HELMET**  
AS/NZS 1801:1997 Type 1 & 2, EN 397:2012, ANSI Z89.1
- **EYE PROTECTOR**  
AS/NZS 13371:2010, ANSI Z87.1:2015, EN 166:2001, EN 14458:2004

RECOMMENDED USES

- **TECHNICAL RESCUE**  
AS/NZS 1801:1997 TYPE 2, OR EN 12492:2012
- **INDUSTRIAL SAFETY**  
AS/NZS 1801:1997 TYPE 1 & 2, EN397:2012, OR ANSI Z89.1

# R7HVS

MULTIPURPOSE SAFETY HELMET

CAP STYLE



Scalloped variation of the R7. Dynamic Sealed Ventilation System (DSVS™) which is watertight when closed. Only R7 compatible with clip on Earmuffs.

CERTIFICATIONS

- **HELMET**  
AS/NZS 1801:1997 Type 1 & 2, EN397:2012, ANSI Z89.1

RECOMMENDED USES

- **TECHNICAL RESCUE**  
AS/NZS 1801:1997 TYPE 2, OR EN 12492:2012
- **INDUSTRIAL SAFETY**  
AS/NZS 1801:1997 TYPE 1 & 2, EN397:2012, OR ANSI Z89.1

# A7A

MULTIPURPOSE SAFETY HELMET

JET STYLE



The A7A is designed for Paramedics who require a full impact liner.

CERTIFICATIONS

- **HELMET**  
AS/NZS 1801:1997, EN 443:2008 PARAMEDIC, OR NFPA 1951:2013

RECOMMENDED USES

- **PARAMEDIC & RESCUE**  
AS/NZS 1801:1997 TYPE 2, EN 443:2008 PARAMEDIC, OR NFPA 1951:2013





## **ATV / QUAD BIKE HELMETS**

Lightweight Quadsafe / ATV  
helmets for farm use

**52-54**



# QUADSAFE ELITE

ATV / QUADBIKE HELMET

CAP STYLE



The Elite edition of our lightweight mutli-size helmet designed for off-road use by ATV users at low speeds (under 30km/h). The Elite is the baseline model.

### CERTIFICATIONS

- HELMET  
NZS 8600:2002, AS/NZS 1801:1997

### RECOMMENDED USES

- |                            |  |
|----------------------------|--|
| FARM BIKE<br>NZS 8600:2002 | INDUSTRIAL SAFETY<br>AS/NZS 1801:1997 TYPE 1 & 2 |
|----------------------------|--|

# QUADSAFE SUPREME

ATV / QUADBIKE HELMET

CAP STYLE



Supreme edition of our lightweight mutli-size helmet designed for off-road use by ATV users at low speeds (under 30km/h). The Supreme comes with extra comfort features.

### CERTIFICATIONS

- HELMET  
NZS 8600:2002, AS/NZS 1801:1997

### RECOMMENDED USES

- |                            |  |
|----------------------------|--|
| FARM BIKE<br>NZS 8600:2002 | INDUSTRIAL SAFETY<br>AS/NZS 1801:1997 TYPE 1 & 2 |
|----------------------------|--|



*RESCUE*  
*WILDLAND FIRE*  
*STRUCTURAL FIRE*  
*INDUSTRIAL*  
*PARAMEDIC*  
*ATV/QUADBIKE*  
*WATER RESCUE*

**PACIFIC HELMETS (NZ) LTD**  
**SAFETY WITHOUT COMPROMISE**

315 HEADS ROAD, WHANGANUI, NEW ZEALAND  
+64 6 344 5019 ■ SALES@PACIFICHELMETS.COM  
WWW.PACIFICHELMETS.COM

